

A Pipe Size In.	App. Wt. Lbs.	D.C. C.I. Body With			DIMENSIONS IN INCHES						S Pipe Size In.	Open Area Sq. In.
		D.C. Top *Z	P.B. Top ZB	N.B. Top ZN	B	D	F	G	K	M		
2	209	\$1327.50	\$1741.20	\$1787.00	15	7	15½	17¾	3	7	5½	45
3	209	1327.50	1741.20	1787.00	15	7	15½	18	3	6½	5½	45
4	209	1327.50	1741.20	1787.00	15	7	15½	18½	3	6	5½	45

†Add For Variations

Galv. (ZG) \$392.90; Clamping Collar (C) \$64.80; Backwater Valve (C) \$118.20; Hinged Grate (H) \$45.70; Aluminum Bucket \$224.30; Secured Grate—Slotted or Vandal Proof Screws—\$28.60.

ENGINEERING SPECIFICATION: ZURN Z-548 15" Diameter Top Heavy Duty Drain, Dura-Coated cast iron body with integral double wall trap, side outlet with seepage pan and heavy duty cast iron slotted grate complete with suspended sediment bucket and plain bronze floor level cleanout. (With backwater valve, specify suffix -V.)

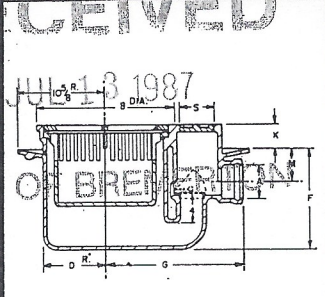

Z-548

15" TOP HEAVY DUTY DRAIN
Cleanout and Trap With Bucket

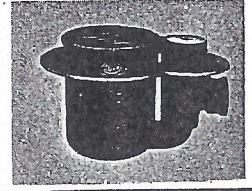

A Pipe Size In.	App. Wt. Lbs.	D.C. C.I. Body With			DIMENSIONS IN INCHES					Open Area Sq. In.
		D.C. Top *Z	P.B. Top ZB	N.B. Top ZN	B	C	E	F†	K	
2	16	\$57.20	\$106.80	\$118.30	9	12¾	1½	3¾	2¾	16
3	16	57.20	106.80	118.30	9	12¾	1½	3¾	2¾	16
4	16	57.20	106.80	118.30	9	12¾	1½	3¾	2¾	16

†Add For Variations

Square Top (T)—Z \$36.20, ZB \$38.10, ZN \$41.90.
Dome Grate (D)—Z \$9.20, ZB \$32.50, ZN \$41.90.
Deflector Grate (G)—Z \$23.00, ZB \$25.20, ZN \$25.20.
Galv. (ZG) \$41.90; Clamping Collar (C) N.C.; Hinged Grate (H) \$28.60; Secondary Strainer (S) \$4.90; Primer Conn. (P) \$18.30; Sediment Bucket (Y) \$15.30; Closure Plug (W) 2", 3" \$43.90; 4" \$74.30; Backwater Valve (V), see Z-1099, Secured Grate—Slotted or Vandal Proof Screws—\$17.20.

ENGINEERING SPECIFICATION: ZURN Z-550 9" Diameter Top Medium Duty Drain, Dura-Coated cast iron body with bottom outlet, seepage pan and medium duty cast iron anti-tilt slotted grate. (With suspended sediment bucket, specify suffix -Y.)

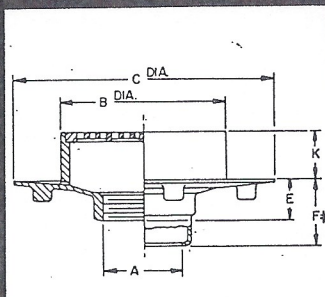

†Caulk and No-Hub

Z-550

9" TOP MED. DUTY DRAIN
Anti-Tilt Grate

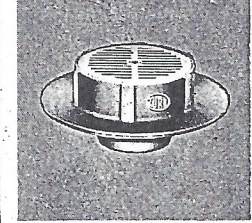

A Pipe Size In.	App. Wt. Lbs.	D.C. C.I. Body With			DIMENSIONS IN INCHES			Open Area Sq. In.
		D.C. Top *Z	P.B. Top ZB	N.B. Top ZN	B	E	F†	
2	11	\$34.30	\$83.90	\$95.40	9	4	5¾	16
3	11	34.30	83.90	95.40	9	4	5¾	16
4	11	34.30	83.90	95.40	9	4	5¾	16

†Add For Variations

Square Top (T)—Z \$36.20, ZB \$38.10, ZN \$41.90.
Dome Grate (D)—Z \$9.20, ZB \$32.50, ZN \$41.90.
Deflector Grate (G)—Z \$23.00, ZB \$25.20, ZN \$25.20.
Galv. (ZG) \$22.90; Hinged Grate (H) \$28.60; Secondary Strainer (S) \$4.90; Primer Conn. (P) \$18.30; Sediment Bucket (Y) \$15.30; Closure Plug (W) 2", 3" \$43.90, 4" \$74.30; Backwater Valve (V), see Z-1099, Secured Grate—Slotted or Vandal Proof Screws—\$17.20.

ENGINEERING SPECIFICATION: ZURN Z-551 9" Diameter Top Medium Duty Drain, Dura-Coated cast iron body with bottom outlet, less seepage pan with medium duty cast iron anti-tilt slotted grate. (With suspended sediment bucket, specify suffix -Y.)

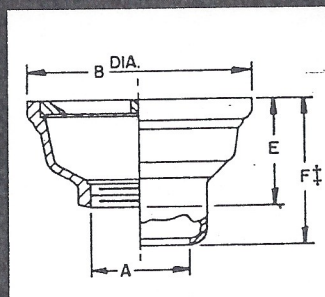

†Caulk and No-Hub

Z-551

9" TOP MED. DUTY DRAIN
Anti-Tilt Grate



A Pipe Size In.	App. Wt. Lbs.	D.C. C.I. Body With			DIMENSIONS IN INCHES						Open Area Sq. In.
		D.C. Top *Z	P.B. Top ZB	N.B. Top ZN	B	C	E	H	K	M	
2	21	\$114.40	\$164.00	\$175.50	9	12¾	5¾	3¾	2¾	3¾	16.0
3	21	114.40	164.00	175.50	9	12¾	6¾	3¾	2¾	4¾	16.0
4	21	114.40	164.00	175.50	9	12¾	6¾	3¾	2¾	3¾	16.0

†Add For Variations

Square Top (T)—Z \$36.20, ZB \$38.10, ZN \$41.90.
Dome Grate (D)—Z \$9.20, ZB \$32.50, ZN \$41.90.
Deflector Grate (G)—Z \$23.00, ZB \$25.20, ZN \$25.20.
Oval Funnel—Z \$51.50, ZB \$99.10, ZN \$106.80.
Galv. (ZG) \$42.00; Clamping Collar (C) N.C.; Hinged Grate (H) \$28.60; Primer Conn. (P) \$18.30; Sediment Bucket (Y) \$15.30; Secured Grate—Slotted or Vandal Proof Screws—\$17.20.

ENGINEERING SPECIFICATION: ZURN Z-552 9" Diameter Top Medium Duty Drain, Dura-Coated cast iron body with side outlet, seepage pan and medium duty cast iron anti-tilt slotted grate. (With suspended sediment bucket, specify suffix -Y.)

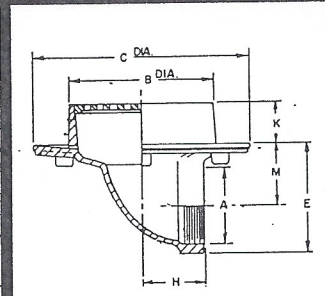

Female I.P. Outlet Regular

Z-552

9" TOP MED. DUTY DRAIN
Anti-Tilt Grate



A Pipe Size In.	App. Wt. Lbs.	D.C. C.I. Body With			DIMENSIONS IN INCHES					Open Area Sq. In.
		D.C. Top *Z	P.B. Top ZB	N.B. Top ZN	B	D	E	H	M	
2	16	\$72.50	\$122.00	\$133.50	9	2½	8¾	3¾	6	16
3	16	72.50	122.00	133.50	9	2½	8¾	3¾	6	16
4	16	72.50	122.00	133.50	9	2½	8¾	3¾	6	16

†Add For Variations

Square Top (T)—Z \$36.20, ZB \$38.10, ZN \$41.90.
Dome Grate (D)—Z \$9.20, ZB \$32.50, ZN \$41.90.
Deflector Grate (G)—Z \$23.00, ZB \$25.20, ZN \$25.20.
Oval Funnel—Z \$51.50, ZB \$99.10, ZN \$106.80.
Galv. (ZG) \$41.90; Hinged Grate (H) \$28.60; Primer Conn. (P) \$18.30; Secured Grate—Slotted or Vandal Proof Screws—\$17.20; Sediment Bucket (Y) \$15.30.

ENGINEERING SPECIFICATION: ZURN Z-553 9" Diameter Top Medium Duty Drain, Dura-Coated cast iron body with side outlet, less seepage pan with medium duty cast iron anti-tilt slotted grate. (With suspended sediment bucket, specify suffix -Y.)

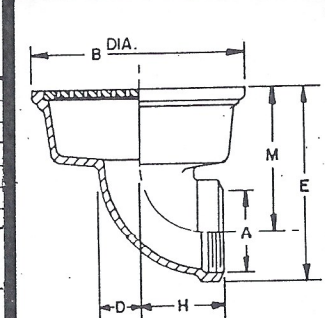

Female I.P. Outlet Regular

Z-553

9" TOP MED. DUTY DRAIN
Anti-Tilt Grate

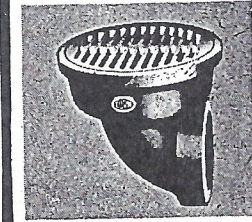

This submittal has been reviewed for compliance with general requirements of design and arrangement only, and is not a contract document and acknowledgement of compliance does not relieve Contractor of responsibility for performance of the work in compliance with all provisions and requirements of the contract documents. Job measurements and coordination of all dimensions for proper fit of all parts of the work and confirmation of all dimensions is specified to meet specific design requirements are and remain specific responsibilities of the Contractor.

- Compliance acknowledged subject to the foregoing; distribute
- Compliance acknowledged as noted and subject to the foregoing; distribute
- Compliance acknowledged as noted and subject to the foregoing; Review and resubmit for record; distribute.

Bovay Northwest Inc.

By LPS Date 7-9-87